

SK METEORI

85M SUBSEA SUPPORT MAINTENANCE VESSEL 200 MEN | DP 2 | FIFI 1

VESSEL PARTICULARS

Class	ABS ✕A1 Ⓢ SPS ✕AMS Offshore Support Vessel FFV 1 ✕DPS-2 ✕ACCU CPS HELIDK Supply-HNLS CRC RW HDC(7.5T/M ² , MAIN DECK)
Flag	Malaysia
P.O.R	Labuan
Year Delivered	2019
Builder	Fujian Southeast Shipbuilding
IMO	9754305
Official Number	900117
Call Sign	9WNNM9

DIMENSION

L.O.A.	85.00 m
Beam	25.00 m
Depth	8.00 m
Draft (max)	6.30 m
GRT	4951
NRT	1485

CARGO CAPACITIES

Deadweight	3163 Tonnes
Deck Cargo	800 Tonnes
Deck Loading	7.5 Tonnes/m ²
Deck Area	735 m ²
Fresh Water	745 m ³
Drill/Bal Water	1757 m ³
Fuel Oil	1168 m ³
Mud	417 m ³
Brine	417 m ³
Dry Bulk	218 m ³

ACCOMMODATION

1 Man cabin	4x 1 (4)
2 Men Cabin	10x 2 (20)
4 Men cabin	42x 4 (168)
Total	192 berths
Hospital	2 berths

PERFORMANCE

Speed	12.8 knots
-------	------------



PROPULSION & POWER PLANT

Propellers	2x 2206KW Azimuth Thrusters
Bow Thruster	2x 800KW, 12T Thrust each
Main Engine	2x 2206KW 800 rpm
Main Generator	3x 830KW, 415V3Ph50Hz
Shaft Generator	2x 1500KW, 415V3Ph50Hz
Emerg Generator	1x 192KW, 415V3Ph50Hz

DECK MACHINERY

Tugger winch	2x 10 Tonnes SWL
Capstan	2x 10 Tonnes SWL
Provision Crane	1x 3 Tonnes SWL @ 14 m radius
4 Points Mooring	4x Electro-Hydraulic Mooring Winches Line pull: 40 Tonnes Brake: 90 Tonnes Drum cap: 1200m x 40mm dia. Wire 4x 5 Tonnes Delta Flipper Anchors
Pedestal Crane	1x 80 Tonnes @ 25 m radius Boom Length: 45m lattice type API 2C, certified for Personnel Lifting

CARGO HANDLING CAPACITY

Fresh Water	1x 150 m ³ /hr @ 75 m head
Drill Water	1x 150 m ³ /hr @ 75 m head
Fuel Oil	2x 150 m ³ /hr @ 75 m head
Water Maker	2x 30 m ³ /day
Dry Bulk	2x 23 m ³ /min @ 5.6 bar

SK METEORI | 85M SUBSEA SUPPORT MAINTENANCE VESSEL

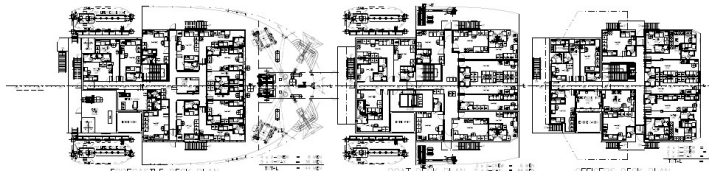
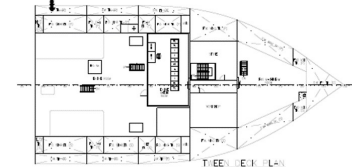
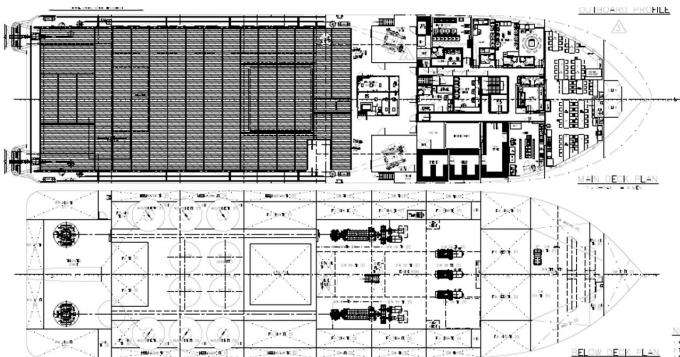
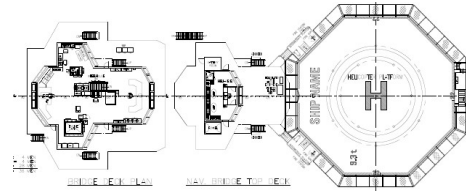
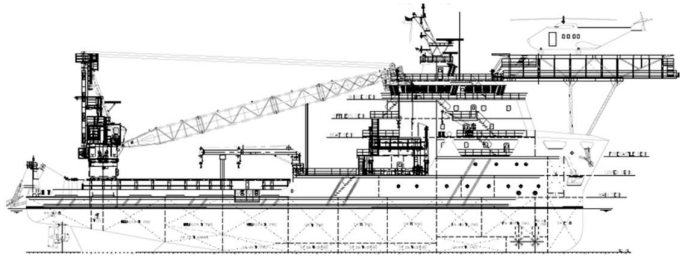

THIS DRAWING AND THE INFORMATION CONTAINED HEREIN ARE SUPPLIED ON THE UNDERSTANDING THAT THEY ARE THE EXCLUSIVE PROPERTY OF FOCAL MARINE & OFFSHORE. THEY MUST NOT BE USED OR REPRODUCED IN WHOLE OR IN PART WITHOUT PERMISSION IN WRITING.

NAVIGATION EQUIPMENT

Radars, Magnetic Compass, Gyro Compasses, DGPSs, AIS Autopilot, Echo Sounder, Speed Log, Navtex, Weather Fax SSAS, BNWAS, (VDR), (ECDIS)

COMMUNICATION EQUIPMENT

GMDSS A1+A2+A3, VSAT

HELIDECK

UK CAP437 D-22, T-9.3T Suit Sikorsky S61-N

FIRE-FIGHTING EQUIPMENT

External FiFi Pump: 2x 2200 m³/hr @ 130m
Monitor: 1x 1200 m³/hr (water/foam)
Monitor: 1x 1200 m³/hr (water)

Oil Dispersant 2x 6m spray booms with nozzles

SAFETY EQUIPMENT

Rescue Boat 1x 6 men Fast Rescue Boat
118 KW in board engine, waterjet

Lifeboat 2x 75 men Life Boats

SKOM SDN BHD (1182610-K)

B-03-B-17-1, Menara 3A, No.3, Jalan Bangsar, KL Eco City, 59200 Kuala Lumpur, Malaysia

Tel : +603-2280 6777 | Fax: +603-2201 7778 | www.skom.com.my

*Disclaimer : All information provide here is accurate at the time of printing and may be subjected to change without prior notice. While every reasonable care has been taken in preparing this document, SKOM Sdn Bhd. Will not be held responsible for any inaccuracies.